

Bridge Rectifiers

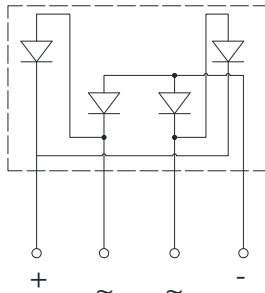
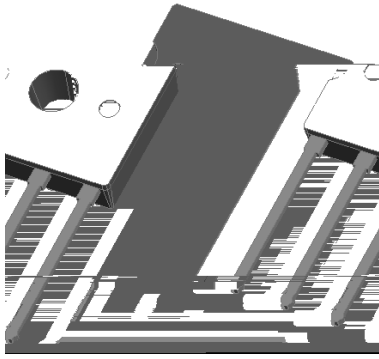

Features

- UL recognition, file #E230084
- Glass passivated chip junction
- Ideal for printed circuit boards
- High surge current capability
- Solder dip 275 °C max. 7 s, per JESD 22-B106

Typical Applications

General purpose use in AC/DC bridge full wave rectification for monitor, TV, printer, power supply, switching mode power supply, adapter, audio equipment, and home appliances applications.

Mechanical Data

- Package:** D3K
- Molding compound meets UL 94 V-0 flammability rating, RoHS-compliant
- Terminals:** Tin plated leads, solderable per J-STD-002 and JESD22-B102
- Polarity:** As marked on body

Maximum Ratings (T_a=25 Unless otherwise specified)

PARAMETER	SYMBOL	UNIT	D2UB05A	D2UB10A	D2UB20A	D2UB40A	D2UB60A	D2UB80A	D2UB100A
Device marking code			D2UB05A	D2UB10A	D2UB20A	D2UB40A	D2UB60A	D2UB80A	D2UB100A
Maximum Repetitive Peak Reverse Voltage	V _{RRM}	V	50	100	200	400	600	800	1000
Maximum RMS Voltage	V _{RMS}	V	35	70	140	280	420	560	700
Maximum DC blocking Voltage	V _{DC}	V	50	100	200	400	600	800	1000
Average rectified output current @60Hz sine wave, R-load	With heatsink T _C =140	I _O	A	2.0					
	Without heatsink T _a =25			1.2					
Forward Surge Current (Non-repetitive) @60Hz Half-sine wave, 1 cycle, T _j =25	I _{FSM}	A	90						
Forward Surge Current (Non-repetitive) @1ms, square wave, 1 cycle, T _j =25			180						
Current squared time @1ms t 8.3ms T _j =25, Rating of per diode	I ² t	A ² s	33						
Storage temperature	T _{stg}		-55 ~ +150						
Junction temperature	T _j		-55 ~ +150						
Dielectric strength @ Terminals to case, AC 1 minute	V _{dis}	KV	2						
Mounting torque @Recommend torque 5kg cm	Tor	kg cm	8						



D2UB05A THRU D2UB100A

Electrical Characteristics $T_a=25$ Unless otherwise specified

PARAMETER	SYMBOL	UNIT	TEST CONDITIONS	D2UB05A	D2UB10A	D2UB20A	D2UB40A	D2UB60A	D2UB80A	D2UB100A
Maximum instantaneous forward voltage drop per diode	V_F	V	$I_{FM}=1.0A$					1.0		
Maximum DC reverse current at rated DC blocking voltage per diode	I_R	μA	$T_j=25$					5		
			$T_j=125$					100		
Typical junction capacitance	C_j	pF	Measured at 1MHz and Applied Reverse Voltage of 4.0 V.D.C					25		

Thermal Characteristics $T_a=25$ Unless otherwise specified

PARAMETER		SYMBOL	UNIT	D2UB05A	D2UB10A	D2UB20A	D2UB40A	D2UB60A	D2UB80A	D2UB100A
Thermal resistance	Between junction and ambient, Without heatsink	R_{J-A}	$^{\circ}C/W$					55.0		
	Between junction and case, With heatsink	R_{J-C}						1.5		

Note: Device mounted on 75mm x 45mm x 5.5mm Aluminum Plate Heatsink.

Ordering Information (Example)

PREFERRED P/N	PACKING CODE	UNIT WEIGHT(g)	MINIMUM PACKAGE(pcs)	INNER BOX QUANTITY(pcs)	OUTER CARTON QUANTITY(pcs)	DELIVERY MODE
D2UB05A - D2UB100A	B1	Approximate 1.358	25	1500	6000	TUBE

Characteristics (Typical)

FIG1: I_o - T_c Curve

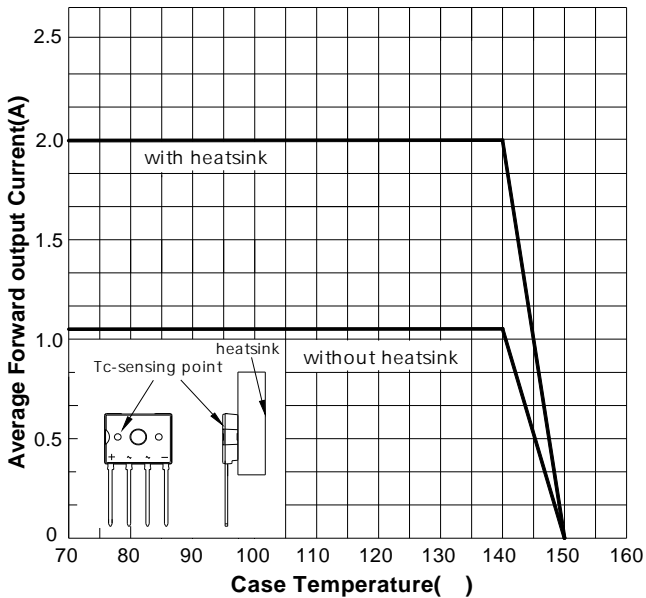
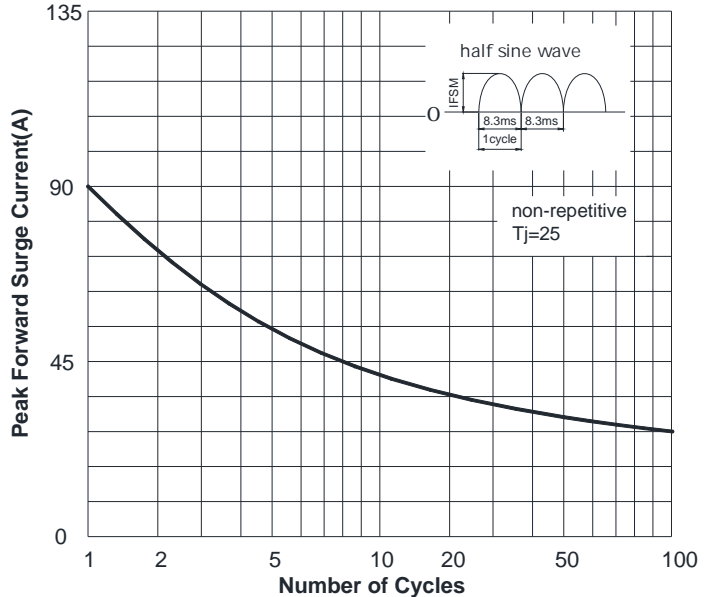
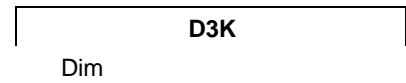

FIG2: Surge Forward Current Capability





Outline Dimensions





D2UB05A THRU D2UB100A

Disclaimer

The information presented in this document is for reference only. Yangzhou Yangjie Electronic Technology Co., Ltd. reserves the right to make changes without notice for the specification of the products displayed here in order to improve reliability, performance, design or otherwise.

The product listed here is designed to be used with ordinary electronic equipment or devices, and not designed to be used with equipment or devices which require a high level of reliability, the malfunction of which would directly endanger human life (such as medical instruments, transportation equipment, aerospace machinery, nuclear-reactor controllers, fuel controllers and safety-critical devices). Yangjie or anyone who purchases it, assumes responsibility for any damages resulting from such improper use of sale.

This publication includes all information. Please refer to the latest Yangjie's sales office for further information. For more details, please visit <http://www.21yangjie.com>, or consult our sales office.